

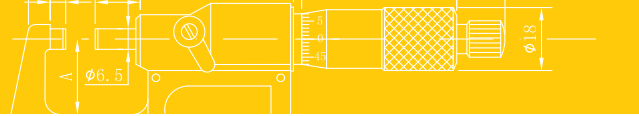

ASIMETO

CATALOG NO. AS1617



Point Micrometers

122 / 126 Series



126-02-1



122-01-1



S-wrench



Battery



Standard

STANDARD ACCESSORIES

- S-wrench, Battery (Digital models), Standard (over 1"/25mm range)
- Warranty card, Instruction manual, Calibration certificate
- Inch/Metric conversion
- Upon switching on the display will read the actual absolute measuring position
- Automatic On/Off to maximize battery life
- Absolute or incremental measuring modes
- Protection level IP65

FEATURES

- Resolution:
 - Digital reading: .00005" / 0.001mm
 - Scale on digital models: .0001" / 0.01mm
 - Scale on mechanical models: .001" / 0.01mm
- 15 degree and 30 degree measuring points are available
- For measuring the web thickness of drills, small grooves, and other hard to reach dimensions
- Carbide tipped measuring faces
- Grey painted steel frame
- Ratchet stop

SPECIFICATIONS

Digital models

Inch		Metric		Anvil Type	Inch		Metric	
Range	Accuracy	Range	Accuracy		Code No.	Code No.		
0-1"	±.0001"	0-25mm	±0.002mm	15°	126-01-1	126-01-0		
1-2"	±.0002"	25-50mm	±0.002mm	15°	126-02-1	126-02-0		
2-3"	±.0002"	50-75mm	±0.003mm	15°	126-03-1	126-03-0		
3-4"	±.0002"	75-100mm	±0.003mm	15°	126-04-1	126-04-0		
0-1"	±.0001"	0-25mm	±0.002mm	30°	126-01-3	126-01-2		
1-2"	±.0002"	25-50mm	±0.002mm	30°	126-02-3	126-02-2		
2-3"	±.0002"	50-75mm	±0.003mm	30°	126-03-3	126-03-2		
3-4"	±.0002"	75-100mm	±0.003mm	30°	126-04-3	126-04-2		

Mechanical models

Inch		Metric		Anvil Type	Inch		Metric	
Range	Accuracy	Range	Accuracy		Code No.	Code No.		
0-1"	±.0001"	0-25mm	±0.004mm	15°	122-01-1	122-01-0		
1-2"	±.0002"	25-50mm	±0.004mm	15°	122-02-1	122-02-0		
2-3"	±.0002"	50-75mm	±0.005mm	15°	122-03-1	122-03-0		
3-4"	±.0002"	75-100mm	±0.005mm	15°	122-04-1	122-04-0		
0-1"	±.0001"	0-25mm	±0.004mm	30°	122-01-3	122-01-2		
1-2"	±.0002"	25-50mm	±0.004mm	30°	122-02-3	122-02-2		
2-3"	±.0002"	50-75mm	±0.005mm	30°	122-03-3	122-03-2		
3-4"	±.0002"	75-100mm	±0.005mm	30°	122-04-3	122-04-2		

Dimension

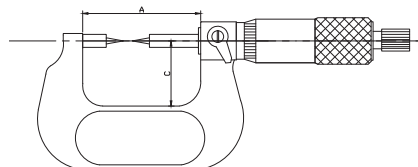
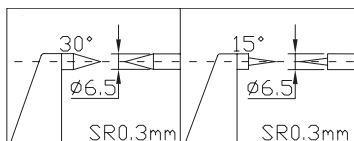

Range	Range	A	C
Inch	Metric	mm	mm
0-1"	0-25mm	57	32
1-2"	25-50mm	82	44.5
2-3"	50-75mm	107	57
3-4"	75-100mm	132.6	69.5