



ASIMETO

CATALOG NO. AS1617

Can Seam Micrometers

162 Series



162-01-0

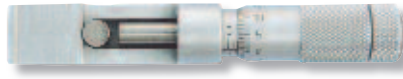

162-01-2

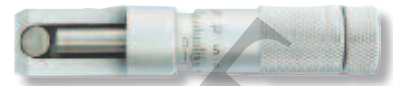

162-01-4

FEATURES

- Graduation: .001" / 0.01mm
- Painted steel frame
- Measures the width, height, and depth of can seams
- The different models correspond to the type of cans as per the chart below



S-wrench

STANDARD ACCESSORIES

- S-wrench
- Warranty card, Calibration certificate

SPECIFICATIONS

Inch	Metric			Inch Code No.			Metric Code No.		
Range	Accuracy	Range	Accuracy	Steel Cans	Aluminum Cans	Aerosol Cans	Steel Cans	Aluminum Cans	Aerosol Cans
0-.6"	±.0001"	0-13mm	±0.004mm	162-01-1	162-01-3	162-01-5	162-01-0	162-01-2	162-01-4

Digital Micrometer Heads

165 Series



165-01-1



S-wrench



Battery

FEATURES

- Resolution: Digital: .00005" / 0.001mm
- Scale: .0001" / 0.01mm
- Protection level IP65
- Inch/Metric conversion
- Upon switching on the display will read the actual absolute measuring position
- Automatic On/Off to maximize battery life
- Extra large LCD readout
- Absolute or incremental measuring modes
- Carbide tipped measuring faces
- Ratchet stop

SPECIFICATIONS

Inch		Metric				Inch	Metric
Range	Accuracy	Range	Accuracy	Measuring face	Clamp Nut	Code No.	Code No.
0-1"	±.0001"	0-25mm	±0.003mm	Flat & Carbide tipped	w/o	165-01-1	165-01-0
0-1"	±.0001"	0-25mm	±0.003mm	Spherical	w/o	165-01-3	165-01-2
0-1"	±.0001"	0-25mm	±0.003mm	With non-rotating device	w/o	165-01-5	165-01-4
0-1"	±.0001"	0-25mm	±0.003mm	Flat & Carbide tipped	with	165-61-1	165-61-0
0-1"	±.0001"	0-25mm	±0.003mm	Spherical	with	165-61-3	165-61-2
0-1"	±.0001"	0-25mm	±0.003mm	With non-rotating device	with	165-61-5	165-61-4
0-2"	±.0002"	0-50mm	±0.005mm	Flat & Carbide tipped	w/o	165-02-1	165-02-0
0-2"	±.0002"	0-50mm	±0.005mm	Spherical	w/o	165-02-3	165-02-2

Dimension

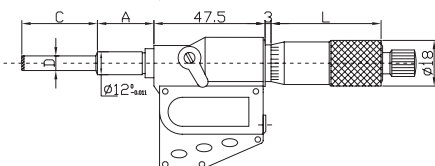

Range	D	A	C	L
0-1"/0-25mm	Φ6.5mm	17.5mm	28.5mm	47mm
0-1"/0-50mm	Φ8mm	35.5mm	53mm	71.5mm